

STILLA

ASSEMBLY INSTRUCTIONS



‘Palmwood’ 6x6

S3011

Every part needed to construct your shed is included inside the pack; cedar panels, doors, windows, hardware kits & roof sheeting. Please ensure you fully unpack all the parts & check against the parts checklist before contacting customer service about anything you believe may be missing. Thank-you!

Caution

Please be careful when handling all components, some parts have sharp metal edges. Always wear work gloves, eye protection and long sleeves when assembling or maintaining your shed.

Tools required for assembly

- Level
- Drill
- Hammer
- Ladder
- 12mm Drill bit
- 6mm Drill bit
- Phillips head drive
- Hex Head Drive (5/16')
- Safety glasses
- Gloves

Before assembly

- Before proceeding with installation, we recommend viewing the Cedar Shed video at www.stilla.com.au/installation/ or search Stilla Classic Cedar Sheds on Youtube. This doesn't show the installation in detail however it could give you some handy tips. Please note we haven't videoed the assembly of each shed however the video online is the Maple 12x6 and will give you an overall idea on how the installation process is completed.
- Remove all parts from packages and place in a safe place close to assembly area.
- Review all instructions; continue to refer to instructions throughout assembly – step by step.

Preparing your site

- If you are installing your shed on the Stilla rebated floor we recommend finding a place in your yard that is very close to level. Pavers or a solid material that will not be affected by weather can be used to perfectly level the shed by placing under the floor frame where required, make sure all members are supported.
- If you are installing your shed on the Stilla heavy duty floor, this can be placed on unlevelled surfaces and levelled up by using the 100x100 stumps provided.



PALMWOOD 6x6 PARTS CHECKLIST

Part Code	Checked	Part Description	Qty
P		Cedar Clad Panel 900x1895mm	6
FP		Cedar Clad Panel 480x1895mm (180x1895 if Double Doors)	2
CD		Single Colonial Door 830x1875mm	1
FG		6 Foot Front Gable	1
BG		6 Foot Back Gable	1
CP		1890x61x18mm Corner Posts	4
CS		1890x40x7mm Cover Strips	3
F		6ft Fascia Pack (4)	1
CT		Collar Tie	1
R		Roof Rafter 870x70x45mm	6
DH		840mm Door Head (1440x42x35mm if Double Doors)	1
DS		840mm Door Step (1440x42x19mm if Double Doors)	1
E		Roof End Piece 203x70x30mm	12
RS		1120mm Roof Sheeting	6
RC		1200mm Ridge Cap	2
C		1060mm Channel	4
N/A		6x6 Hardware Kit	1
IM		6x6 Instruction Manual	1
REP		Roof End Plate 1714x70x45mm	4

Floor Kit – Option

Floor Frame - 140x38mm

Part Code	Checked	Part Description	Qty
EP		End Plate 1884x140x38mm	2
DJ		Double Joist 1724x140x38mm	2
SJ		Single Joist 1724x140x38mm	3
L		Logs 750x100x100mm	4
FB		1798mm x 800	2
FB		1798mm x 111	1

Double Doors – Option – Changes to above kit

Part Code	Checked	Part Description	Qty
CD		Colonial Door 714x1875mm	2
FP		Front Panel 180x1895mm	2
DP		Door Leaver Packer 100x100x18mm	1
DS		Door Stop 1440x42x19	1
DH		Door Head 1440x42x35	1



If no floor option was purchased, go to step 2.0 (Wall Assembly)

SKIP TO BACK FOR IMAGES TO HELP WITH FLOOR INSTALL

STEP 1.0

FLOOR KIT

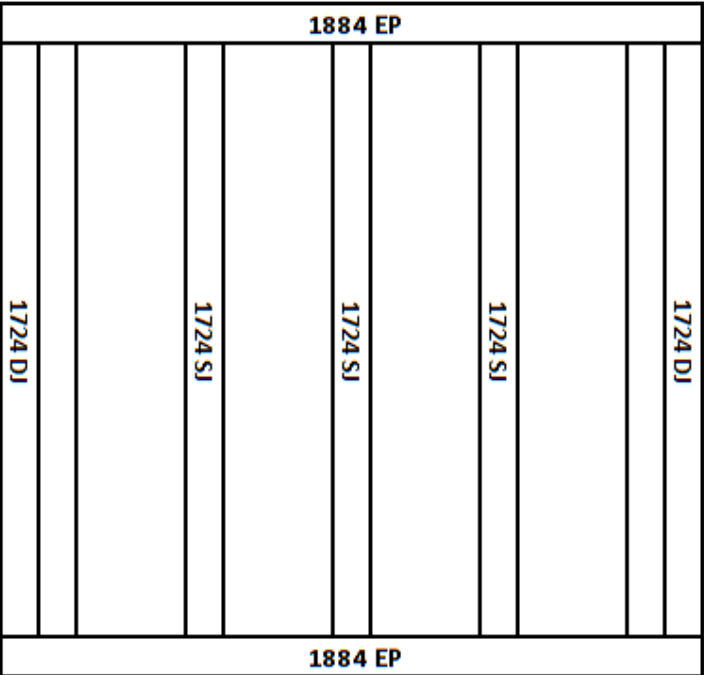
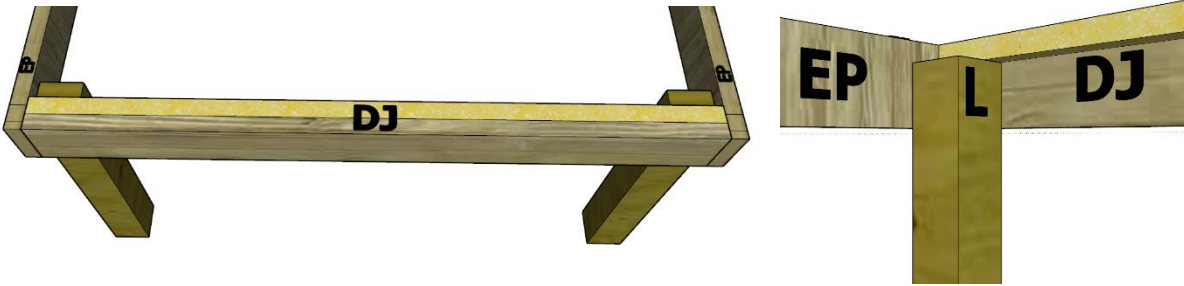
1.0 – FLOOR KIT		
PART CODE	QTY	DESCRIPTION
EP	2	End Plate 1884mm
SJ	3	Single Joist 1724mm
DJ	2	Double Joist 1724mm
100BS	24	100mm Batten Screw
1.0 – FLOOR FRAME		
Fasten floor frame together as indicated in diagram below, using lines and predrilled holes. Screw through EP into DJ using 3x 100BS. Screw through EP into SJ using 2 x 100BS per join. Ensure frame is square by measuring from corner to corner diagonally, frame will be square when both diagonal measurements equal the same.		
		
		
ENSURE 42x35 side of the DJ sits at top.		



STEP 1.1

FLOOR FRAME INSTALLATION

The 6x6 floor frame comes in one part. Install floor frame in desired position at desired height and fasten to logs once level and square.

1.1 – FLOOR FRAME INSTALLATION

PART CODE	QTY	DESCRIPTION
L	4	Logs 750x100x100mm
100BS	16	100mm batten screws
200PB	4	200mm M12 Post Bolt
W	8	M12 Washers

1.1 – FLOOR FRAME INSTALLATION

1. Lay out frame in desired position and mark holes to dig, as indicated on diagram below (use shovel or marking paint).
2. Dig and place logs in holes (using concrete if you wish).
3. Fasten floor frame to logs at desired height, using 4x 100BS per log, ensuring frame is level*.

** Fasten frame to logs when roughly level and then critique by hammering in or adding dirt (or concrete) to corners until perfectly level at every post.*

Once frame is installed, predrill holes (using a 13mm drill bit) and bolt each log to the floor frame in spots indicated with 200PB, using washers on both sides.

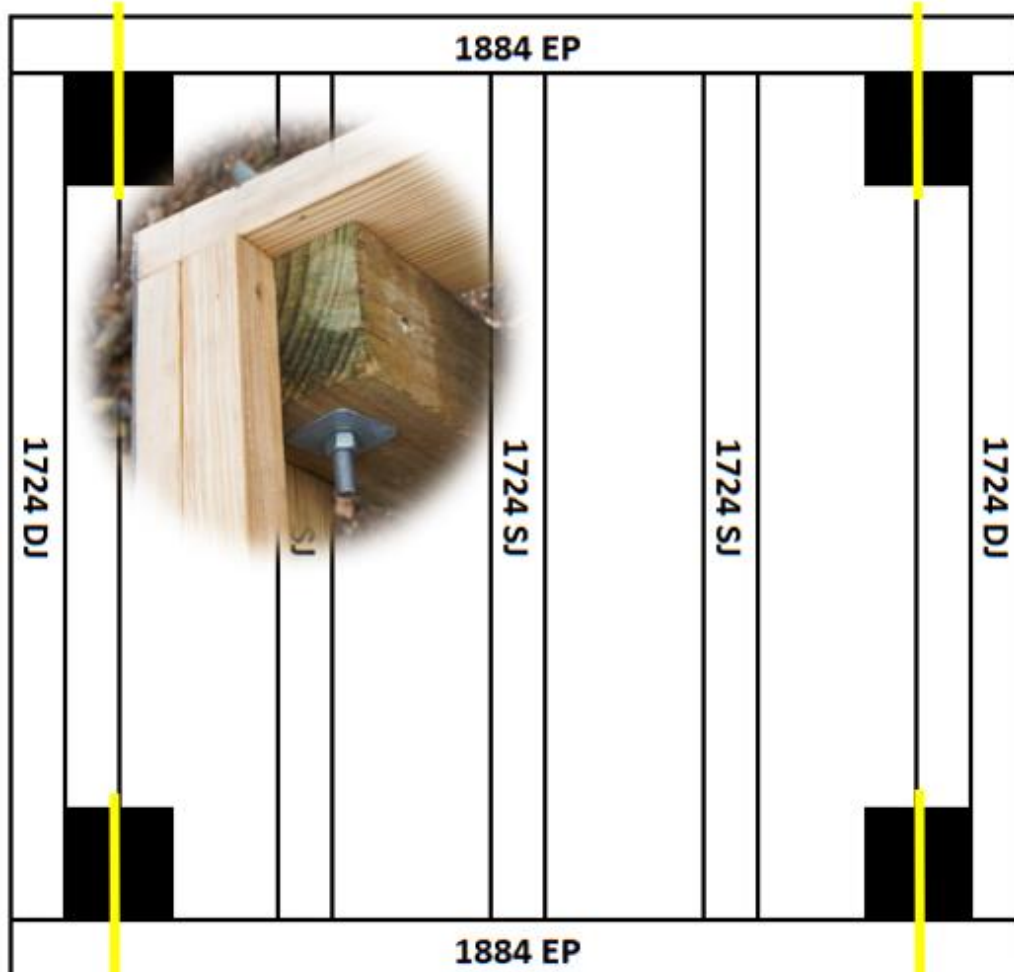

STEP 1.2

FLOOR INSTALLATION

1.2 – FLOORING INSTALLATION

PART CODE	QTY	DESCRIPTION
FB	2	Floor Board 1798x800mm
FB	1	Floor Board 1798x111mm
50PS	35	50mm Philips Screw

1.2– FLOORING INSTALLATION

Fasten floor sheets to floor frame as shown in diagram below using 50PS.
Bring Floor sheets in **43mm** on all 4 sides from the outside of the floor frame.

Note- The x marked on the floor sheets do not line up with out joists.

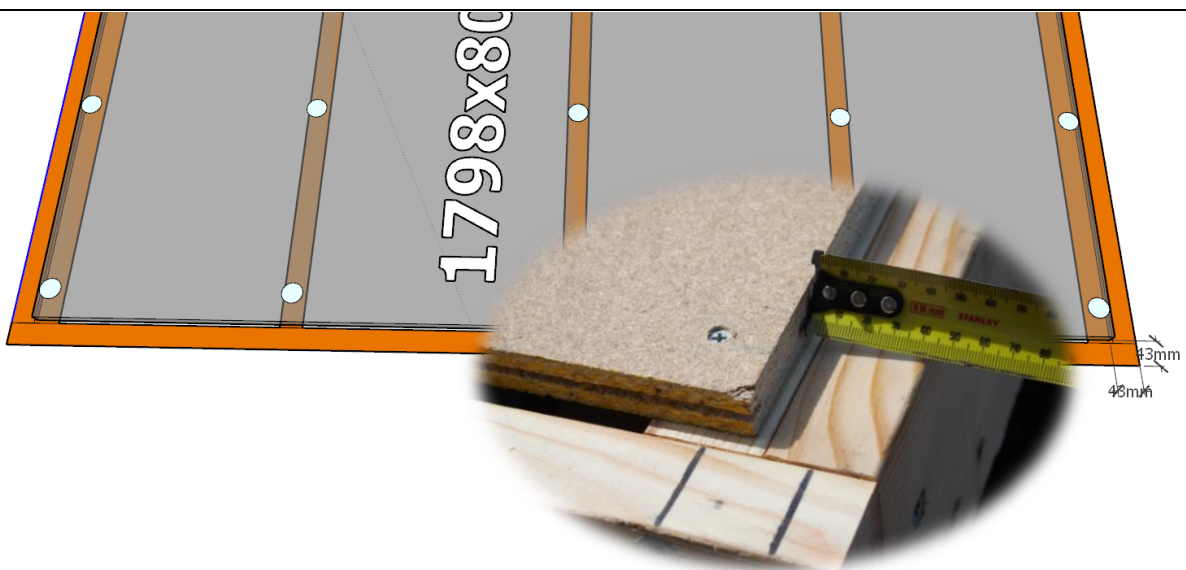
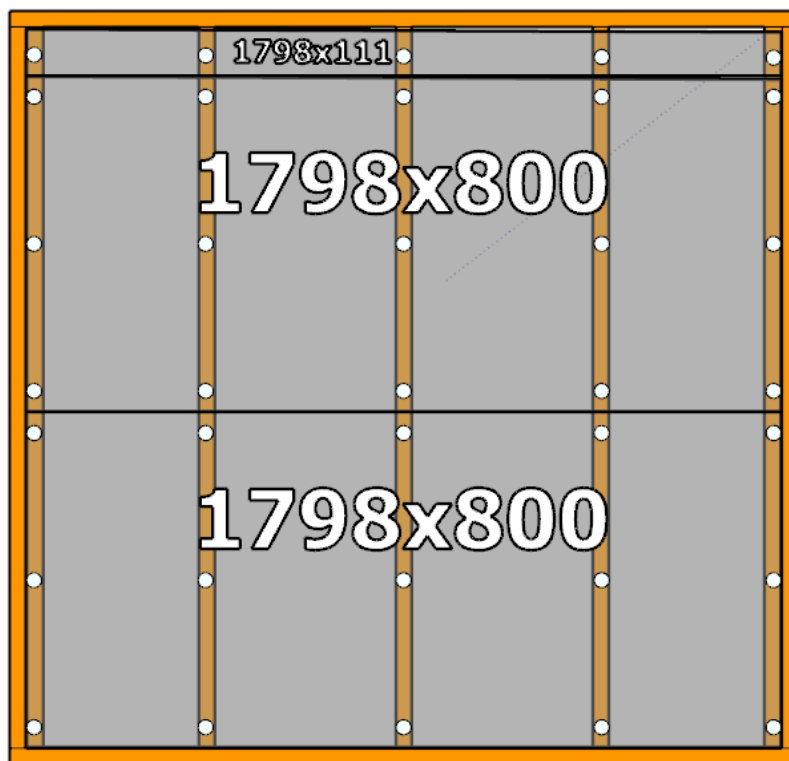

STEP 2.0

WALL ASSEMBLY

2.0 - ASSEMBLY PARTS – WALL ASSEMBLY

PART CODE	QTY	DESCRIPTION
FP	1	480mm Wall panel (If double doors chosen – 180mm Panel)
P	1	900mm Wall panel
65HHS	3	65mm Hex head screw

- If optional window was purchased, it can take the place of any (P) panel.

2.0 - ASSEMBLY – WALL ASSEMBLY

Screw through FP into P (top, centre & bottom) using 3 x 65HHS. (Holding studs flush on the outside)

Note: Ensure tongue on VJ cladding is facing upwards.

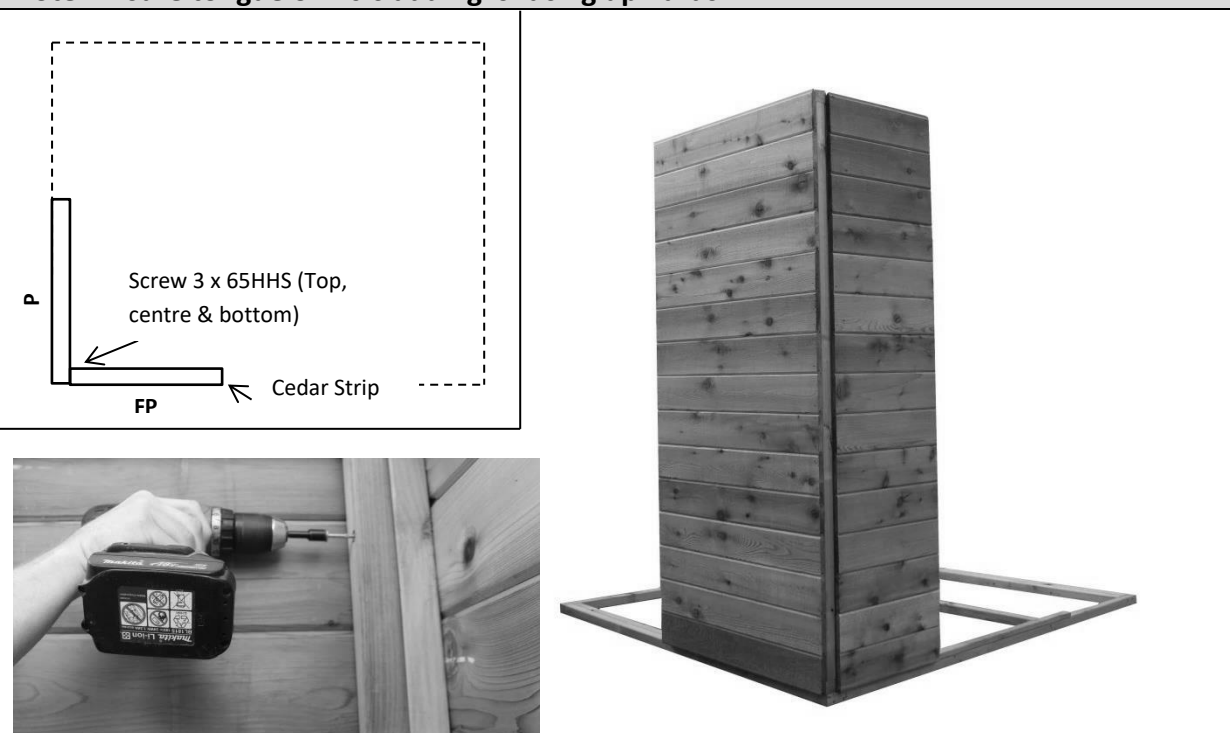

When screwing the four corners together please make sure the studs are flush on the outside (not the inside) as per image below.



STEP 2.1

WALL ASSEMBLY

2.1 - ASSEMBLY PARTS – WALL ASSEMBLY

PART CODE	QTY	DESCRIPTION
P	1	900mm Wall panel
65HHS	3	65mm Hex head screw

2.1 - ASSEMBLY – WALL ASSEMBLY

Screw through P into P (Top, centre & bottom) using 3 x 65HHS, holding studs flush on the **inside**.

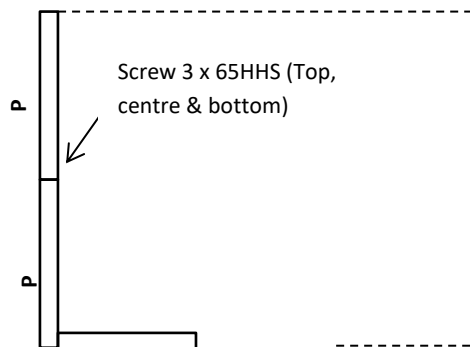

FRONT OF SHED



STEP 2.2

WALL ASSEMBLY

2.2 - ASSEMBLY PARTS – WALL ASSEMBLY

PART CODE	QTY	DESCRIPTION
P	1	900mm Wall panel
65HHS	3	65mm Hex head screw

2.2 - ASSEMBLY – WALL ASSEMBLY

Screw through P into P (Top, centre & bottom) using 3 x 65HHS, holding studs flush on the **outside**.

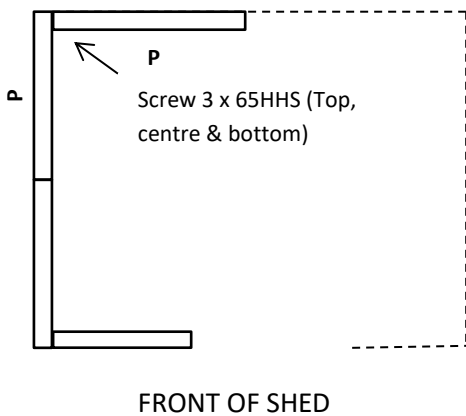

STEP 2.3

WALL ASSEMBLY

2.3 - ASSEMBLY PARTS – WALL ASSEMBLY

PART CODE	QTY	DESCRIPTION
P	1	900mm Wall panel
65HHS	3	65mm Hex head screw

2.3 - ASSEMBLY – WALL ASSEMBLY

Screw through P into P (Top, centre & bottom) using 3 x 65HHS, holding studs flush on the **inside**.

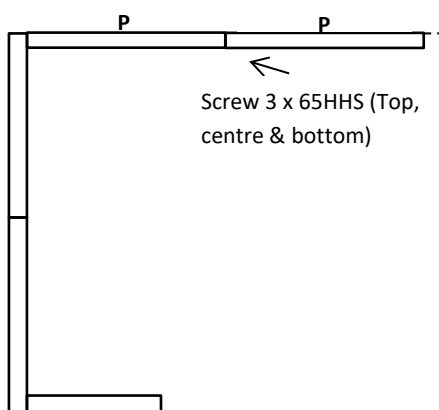

FRONT OF SHED



STEP 2.4

WALL ASSEMBLY

2.4 - ASSEMBLY PARTS – WALL ASSEMBLY

PART CODE	QTY	DESCRIPTION
P	1	900mm Wall panel
65HHS	3	65mm Hex head screw

2.4 - ASSEMBLY – WALL ASSEMBLY

Screw through P into P (top, centre & bottom) using 3 x 65HHS holding studs flush on the **outside**.

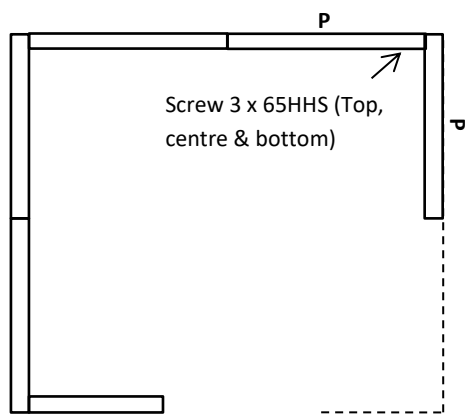

STEP 2.5

WALL ASSEMBLY

2.5 - ASSEMBLY PARTS – WALL ASSEMBLY

PART CODE	QTY	DESCRIPTION
P	1	900mm Wall panel
65HHS	3	65mm Hex head screw

2.5 - ASSEMBLY – WALL ASSEMBLY

Screw through P into P (top, centre & bottom) using 3 x 65HHS holding studs flush on the **inside**.

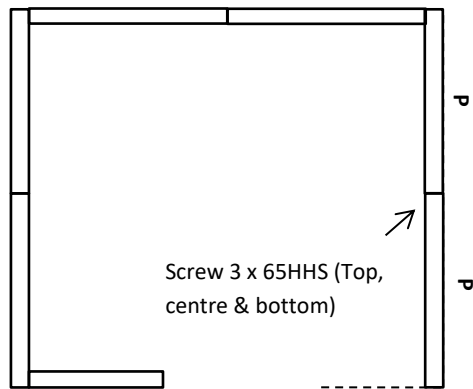

FRONT OF SHED



STEP 2.6

WALL ASSEMBLY

2.6 - ASSEMBLY PARTS – WALL ASSEMBLY

PART CODE	QTY	DESCRIPTION
FP	1	480mm Wall panel (If double doors chosen – 180mm Panel)
65HHS	3	65mm Hex head screw

2.6 - ASSEMBLY – WALL ASSEMBLY

Screw through FP into P (top, centre & bottom) using 3 x 65HHS holding studs flush on the **outside**.

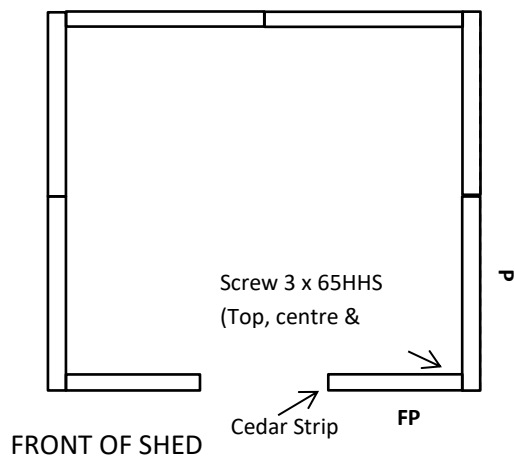

STEP 2.7

DOOR STEP INSTALL

2.7 - ASSEMBLY PARTS – DOOR STEP INSTALL

PART CODE	QTY	DESCRIPTION
DS	1	840x42x19mm Door Step (Replace with 1440 DS if DD)
DS	1	1440x42x19mm Door Step (ONLY IF DOUBLE DOOR OPTION PURCHASED)
40N	4	40mm Nail

2.7 - ASSEMBLY – DOOR STEP INSTALL

Nail Door Step in position using 4x 40N* as seen below. Ensure wall panels are tight against DS.

** This is if floor option was chosen. If you are installing on concrete slab, use small dyno bolts to fasten (not provided).*

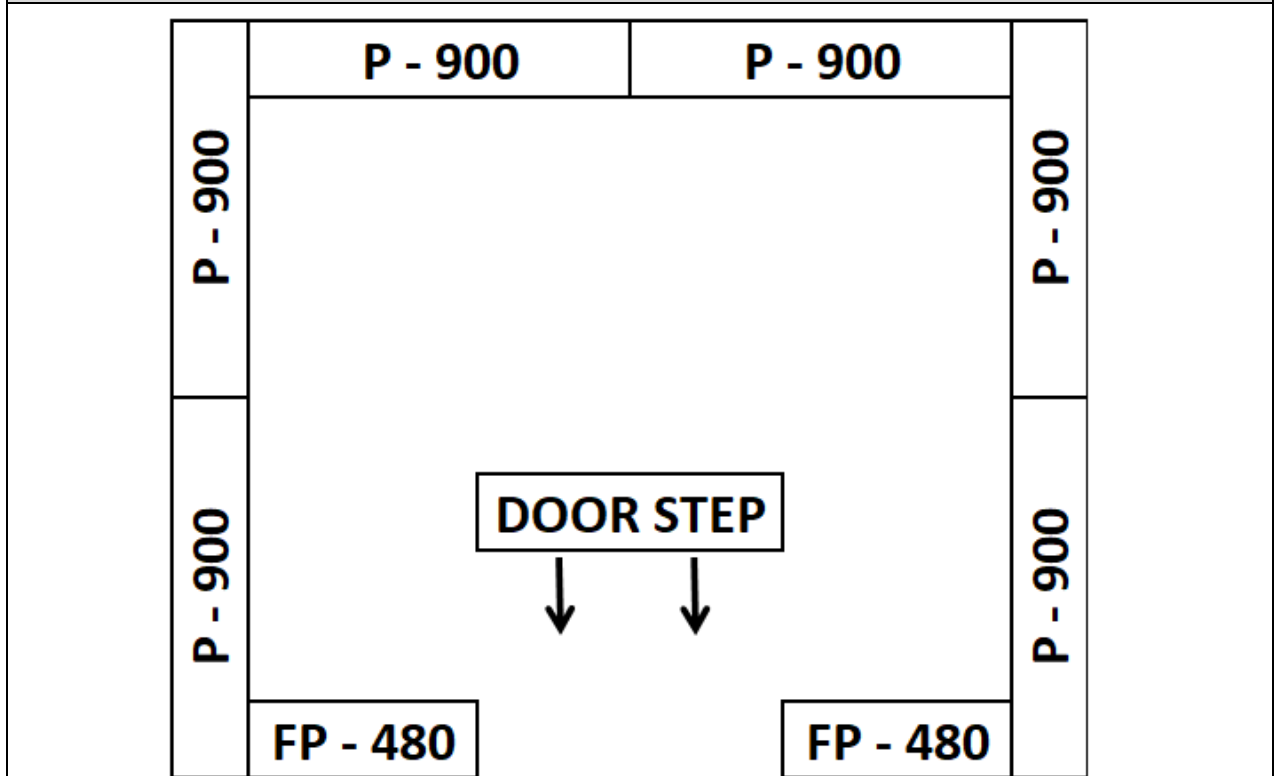

STEP 2.8

DOOR HEAD ASSEMBLY

2.8 - ASSEMBLY PARTS – DOOR HEAD ASSEMBLY		
PART CODE	QTY	DESCRIPTION
	1	Front End 6ft Gable
DH	1	840x42x35mm Door Head (replace with 1440mm DH if DD)
DH	1	1440x42x35mm Door Head (ONLY IF DD OPTION PURCHASED)
65HHS	4	65mm Hex head screw

2.8 - ASSEMBLY – DOOR HEAD ASSEMBLY

Measure and mark middle of Door Head (DH)*. Lay Assembled front end Gable on a flat surface with the frame facing upwards, as seen below. Line up middle mark on DH with gable join centre, hold and screw down through gable into DH using 4x 65HHS- 2 either side of gable join (as seen below).

* 420mm mark for SD / 720mm mark for DD.



STEP 2.9

FRONT END GABLE INSTALL

2.9 - ASSEMBLY PARTS – FRONT END GABLE INSTALL

PART CODE	QTY	DESCRIPTION
FG	1	Front End 6ft Gable
65HHS	4	65mm Hex head screw

2.9 - ASSEMBLY – FRONT END GABLE INSTALL

Carefully place assembled gable on front wall, ensuring groove on gable slots into the tongue on the wall, as seen below. Ensure end of gable sits flush with side of back wall panel and fasten by screwing 4x 65HHS through panels into gable- 2 screws either side of join.



Ensure groove slots into tongue



Screw upwards through wall panel into gable



STEP 3.0

BACK END GABLE INSTALL

3.0 - ASSEMBLY PARTS – BACK END GABLE INSTALL

PART CODE	QTY	DESCRIPTION
BG	1	Back End 6ft Gable
65HHS	4	65mm Hex head screw

3.0 - ASSEMBLY – BACK END GABLE INSTALL

Carefully place assembled gable on back wall, ensuring groove on gable slots into the tongue on the wall, as seen below. Ensure end of gable sits flush with side of back wall panel and fasten by screwing 4x 65HHS through panels into gable- 2 screws either side of join.

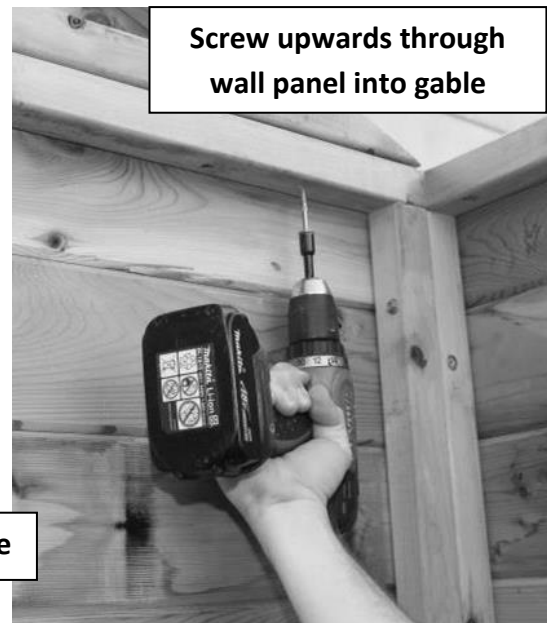

STEP 4.0

ROOF FRAME ASSEMBLY

4.0 - ASSEMBLY PARTS – ROOF ASSEMBLY (REPEAT TWICE)

PART CODE	QTY	DESCRIPTION
REP	2	Roof End Plate 1714x70x45mm
R	3	Roof Rafter 870x70x45mm
75BS	12	75mm Batten Screw

4.0- ASSEMBLY – ROOF ASSEMBLY (1 of 2 frames)

It helps to find a flat, level surface to complete this process on.

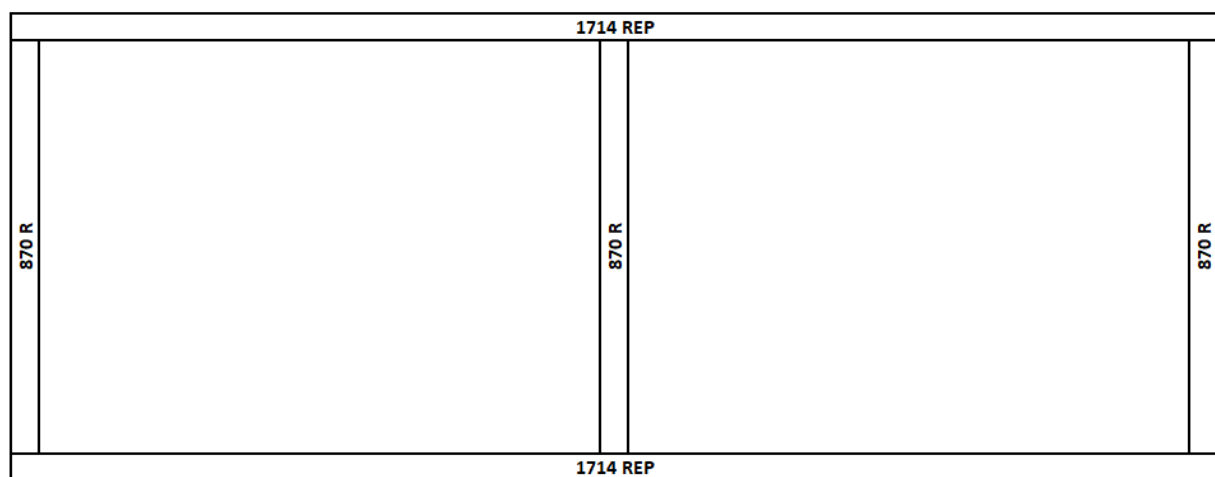

1. Place 3x Roof Rafters (R) in between REPs as seen in diagram above and screw 75BS into predrilled holes to assemble roof frame.

Repeat this twice.



REPEAT THIS ASSEMBLY PROCESS TWICE TO COMPLETE BOTH ROOF FRAMES READY FOR ROOF SHEETING



STEP 4.1

ROOF ASSEMBLY

4.1 - ASSEMBLY PARTS – ROOF ASSEMBLY (ROOF SHEETS)

PART CODE	QTY	DESCRIPTION
RS	2	1120mm roof sheet
40RS	2	40mm Roof screw
25RS	2	25mm Roof screw

4.1 - ASSEMBLY – ROOF ASSEMBLY (ROOF SHEETS)

It helps to find a flat, level surface to complete this process on.

Position roof sheets (RS) at either end of roof frame and fasten in place as indicated in diagrams. Lay roof sheet (bent edge) flush with top of roof frame while hanging side of roof sheet **203mm*** over end of roof frame. Once in position, screw 25RS through pan at top** FIRST and then (checking bottom is still overhanging 203mm from side) screw a 40RS through rib at the bottom** to fasten roof sheet in place.

** Use 203mm "E" or tape measure when placing overhanging side of roof sheet (ENSURE ROOF SHEET RUNS PARRELEL TO ROOF FRAME END).*

*** Only screw 25RS in pan at the top and 40RS in the bottom of roof sheet.*

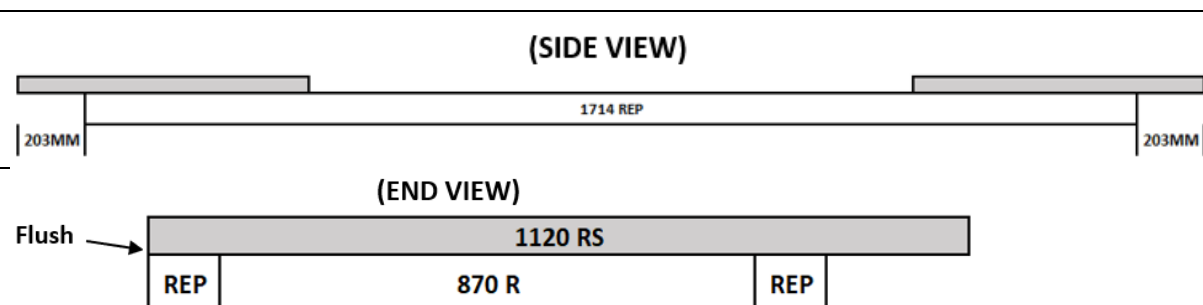
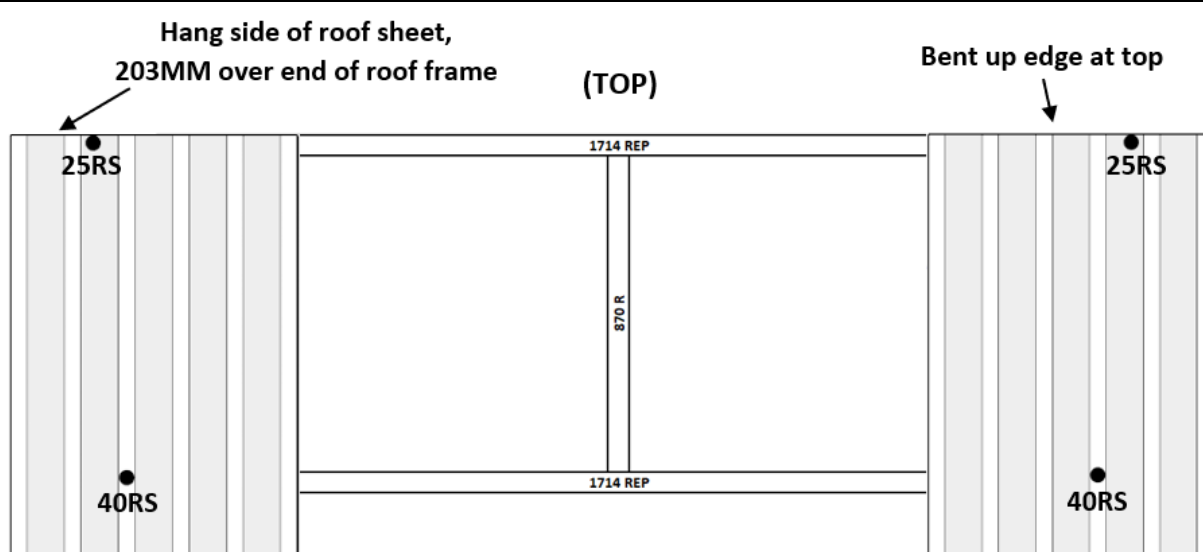

REPEAT THIS STEP FOR SECOND ROOF FRAME



STEP 4.2

ROOF ASSEMBLY

4.2 - ASSEMBLY PARTS – ROOF ASSEMBLY (ROOF SHEETS)

PART CODE	QTY	DESCRIPTION
RS	1	1120mm roof sheet
40RS	2	40mm Roof screw
25RS	4	25mm Roof screw

4.2 - ASSEMBLY – ROOF ASSEMBLY (ROOF SHEETS)

Complete laying roof sheeting out on frame. Fasten roof sheets to battens in sequence shown. 1 x 25RS either side of join at top and 1 x 40RS through rib join at bottom.

Note: Use straight edge to keep all screws in line and centre of batten.

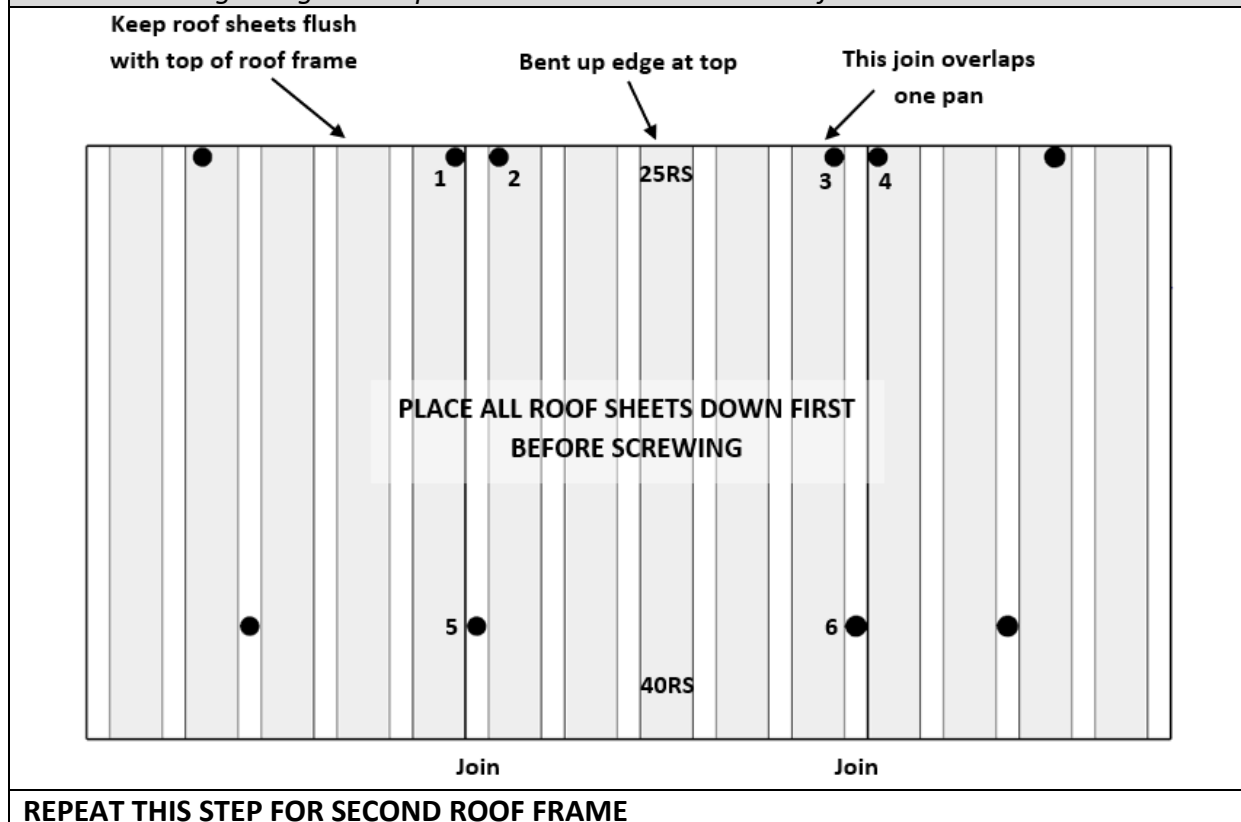

STEP 4.3

ROOF ASSEMBLY

4.3 - ASSEMBLY PARTS – ROOF ASSEMBLY

PART CODE	QTY	DESCRIPTION
40RS	7	40mm Roof screw
25RS	10	25mm Roof screw

4.3 - ASSEMBLY – ROOF ASSEMBLY

Complete screwing roof off at top. 1 x 25RS in pan beside every rib. Once top is complete screw bottom off using 1 x 40RS through every rib.

Note: Use straight edge to keep all screws in line and centre of batten.

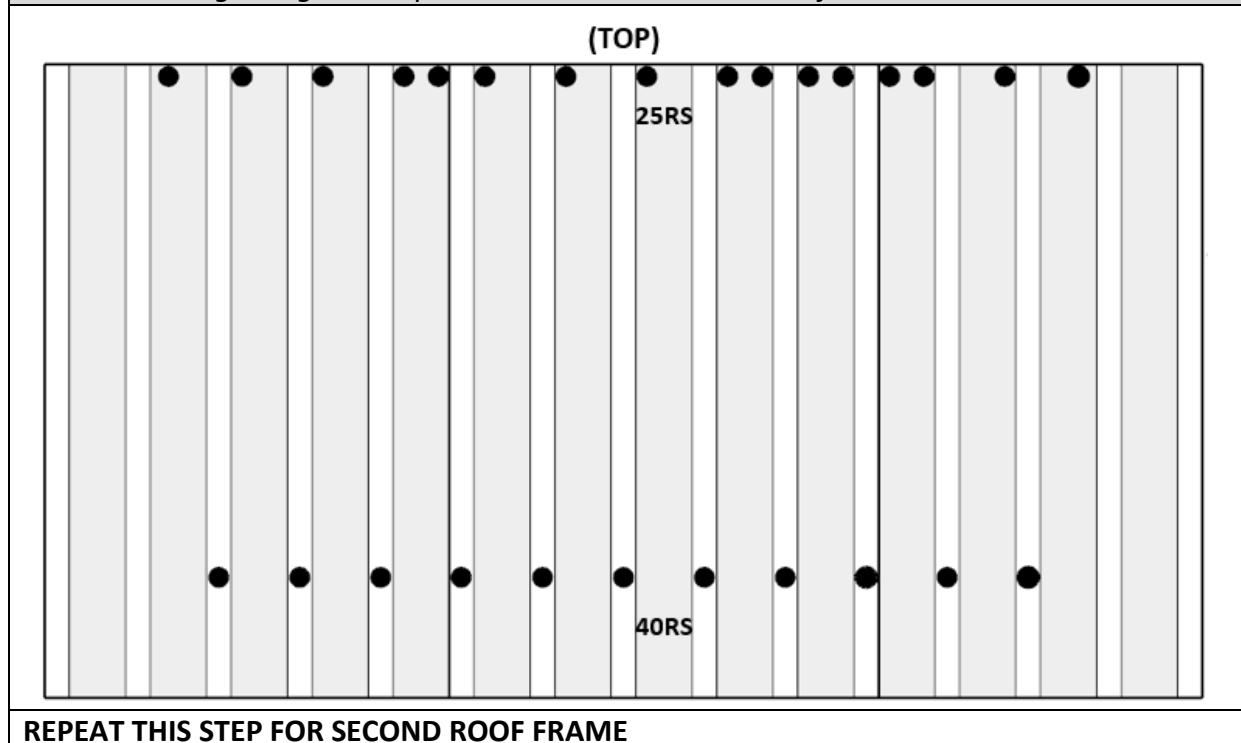

REPEAT THIS STEP FOR SECOND ROOF FRAME



STEP 4.4

CHANNEL ASSEMBLY

4.4 - ASSEMBLY PARTS – CHANNEL ASSEMBLY

PART CODE	QTY	DESCRIPTION
ST	5	12mm self-tapping screw
C	2	Roof Channel

4.4 - ASSEMBLY – CHANNEL ASSEMBLY

Slide Roof channel onto end of roof sheeting overhang. Fasten in place using ST.

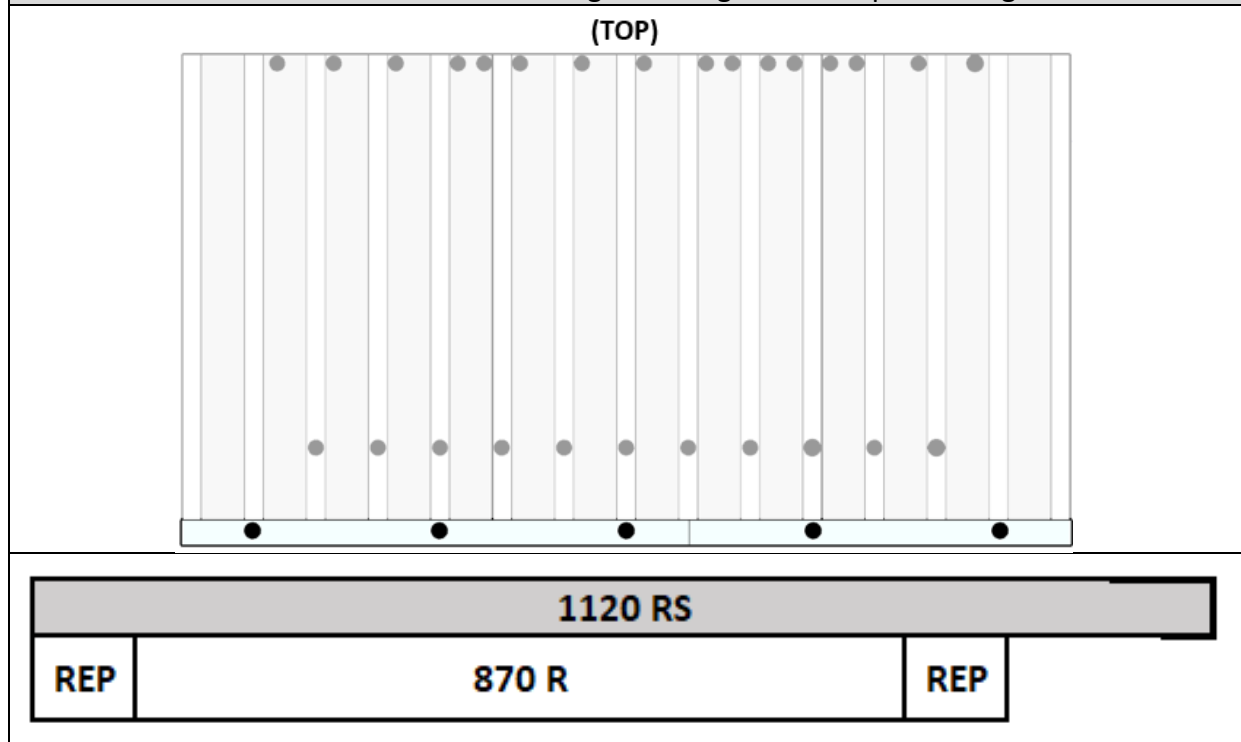

REPEAT TASKS 4.0 – 4.4 TO COMPLETE THE OTHER ROOF PANEL.

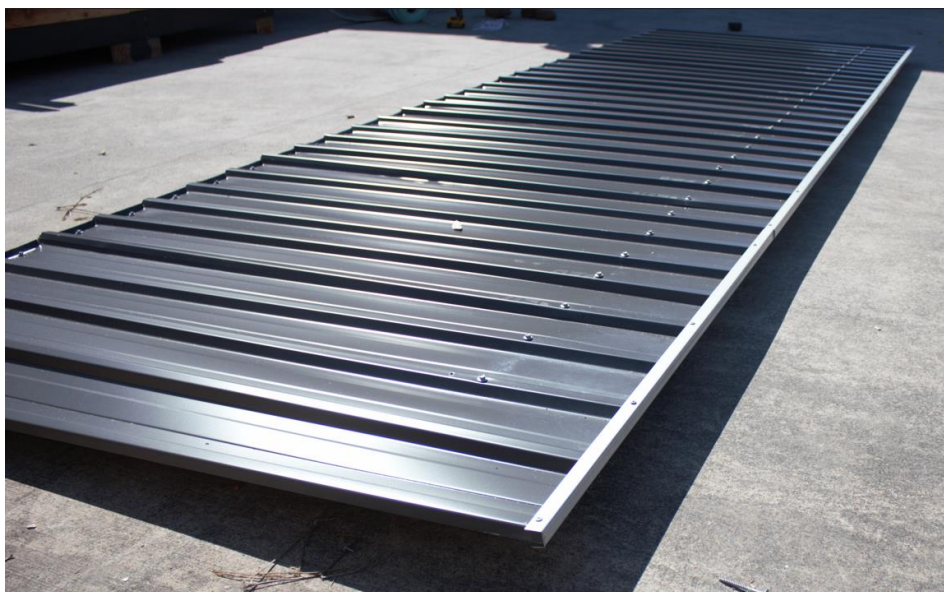

STEP 4.5

ROOF END PIECE

4.5 - ASSEMBLY PARTS – RIDGE BEAM BRACKET

PART CODE	QTY	DESCRIPTION
E	12	Roof End Piece 203x70x30mm
65BS	12	65 Batten Screws

4.5 - ASSEMBLY – ROOF END PIECES TO GABLES

Standing inside shed on ladder, screw roof end pieces to top of gable in required positions using 1x 65BS per piece. See positions in photo below. Lay 70mm side flat on top of gable with 70x30mm face flush with inside of gable frame and screw in place (6 pieces per gable).

Note: It is advised to predrill through the E first with a 4mm drill bit, before securing to gable.

Repeat this step on both gables.

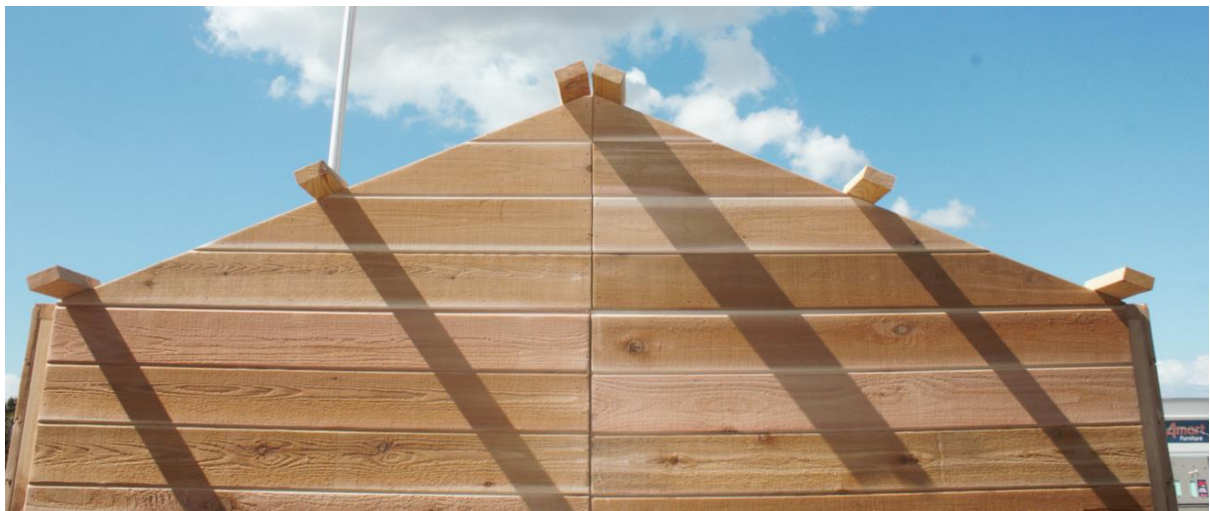

STEP 4.6

ROOF INSTALLATION

4.6 - ASSEMBLY PARTS – ROOF INSTALLATION

PART CODE	QTY	DESCRIPTION
	2	Completed roof panels
75BS	24	75mm Batten Screw

4.6 - ASSEMBLY – ROOF INSTALLATION

Slide roof frame into position. Ensure point of roof frame is flush with middle of gable as seen below. Fasten to ends using 3x 75BS, screw through roof frame into gable frame. Fasten to sides using 6x 75BS evenly spaced, screw through roof frame into side wall top plates. Meet second roof frame up with the first and repeat steps for fastening.

This task will require 2 or more persons to complete.



STEP 4.7

ROOF INSTALATION

4.7 - ASSEMBLY – ROOF INSTALLATION

PART CODE	QTY	DESCRIPTION
40RS	8	40mm Roof Screws
25RS	8	25mm Roof Screws

4.7 – ASSEMBLY – ROOF INSTALLATION

Fully fasten down the roof sheeting onto the Roof End Pieces (E) as seen below. Use 2x 25RS to screw into the top E of each side and 2x 40RS to screw into the bottom E of each side.

Note: there is four sides.



STEP 4.8

COLLAR TIE INSTALLATION

4.8 – ASSEMBLY PARTS – COLLAR TIE INSTALLATION

PART CODE	QTY	DESCRIPTION
CT	1	Collar tie
40RS	6	40mm Roof Screw
75BS	6	75mm Batten Screw

4.8- ASSEMBLY – COLLAR TIE INSTALLATION

Holding Collar tie tight and level in position screw through CT into Roof Rafters in predrilled holes, using 6x 40RS per collar tie.

Fasten roof frames together by screwing 75BS evenly space along the top of the roof frames.



If Double door option was chosen please go to step 5.4

STEP 5.0

DOOR HINGE ASSEMBLY

5.0 - ASSEMBLY PARTS –DOOR HINGE ASSEMBLY

PART CODE	QTY	DESCRIPTION
H	2	Hinge
HS	6	Hinge Screw
CD	1	Door

5.0 - ASSEMBLY –DOOR HINGE ASSEMBLY

Place door on back and hold hinge (H) in position. Fasten hinges to door using 3 x hinge screws (HS) per hinge.

Position: Hinges are to be placed at top and bottom of door. They are to be centralised over bracing on back of door (as per second and third image below)

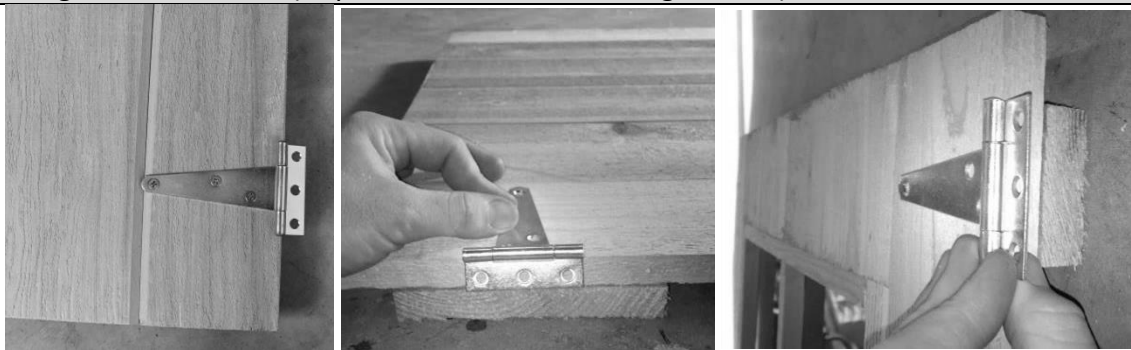

STEP 5.1

DOOR INSTALLATION

5.1 - ASSEMBLY PARTS –DOOR INSTALLATION

PART CODE	QTY	DESCRIPTION
CD	1	Door
HS	6	Hinge screw

5.1 - ASSEMBLY –DOOR INSTALLATION

Hold door in position, 3mm down from top. Front of the door when closed will be flush with front of VJ cladding.

Screw through hinge into front wall (as pictured).



STEP 5.2

DOOR HANDLE ASSEMBLY

5.2 - ASSEMBLY PARTS – DOOR HANDLE ASSEMBLY

PART CODE	QTY	DESCRIPTION
TH	1	T Handle

5.2 - ASSEMBLY – DOOR HANDLE ASSEMBLY

Remove bolts and lever from back of T Handle (TH). Mark and drill 12mm centre hole in position shown, 50mm in from door edge.

Insert T handle in position and mark two outside holes. Remove T handle and drill 2 x 6mm holes.

Insert T handle back in with bolts, and fasten nuts on back of door.



STEP 5.3

DOOR HANDLE ASSEMBLY

5.3 - ASSEMBLY PARTS – DOOR HANDLE ASSEMBLY

PART CODE	QTY	DESCRIPTION
	1	T Handle Lever

5.3 - ASSEMBLY – DOOR HANDLE ASSEMBLY

Holding door in closed position, flush with VJ cladding on front - slide lever onto T Handle and tighten once hitting on wall stud beside door.



If Double door option was not chosen please go to step 6.0

STEP 5.4

DOUBLE DOOR HINGE ASSEMBLY

5.4 - ASSEMBLY PARTS – DOUBLE DOOR HINGE ASSEMBLY

PART CODE	QTY	DESCRIPTION
H	4	Hinge
HS	12	Hinge Screw
CD	2	Doors

5.4 - ASSEMBLY – DOUBLE DOOR HINGE ASSEMBLY

Place door on back and hold hinge (H) in position. Fasten hinges to door using 3 x hinge screws (HS) per hinge.

Position: Hinges are to be placed at top and bottom of door. They are to be centralised over bracing on back of door (as per second and third image below)

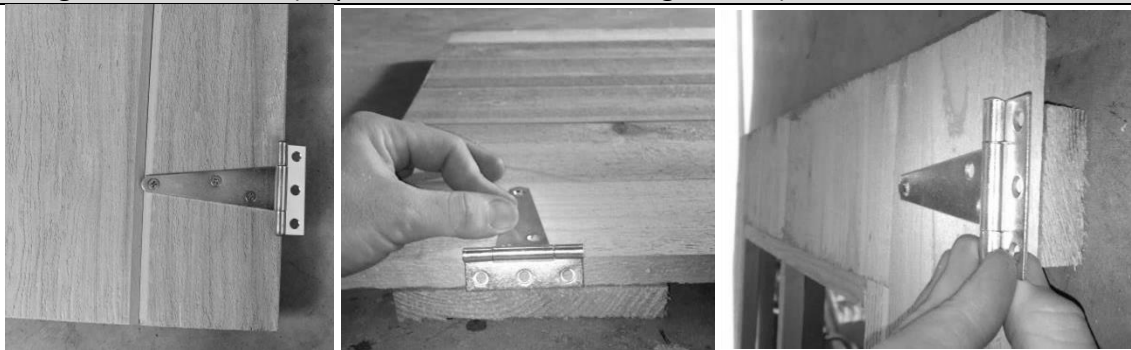

Repeat Step 5.4 with second door.



STEP 5.5

DOUBLE DOOR INSTALLATION

5.5 - ASSEMBLY PARTS – DOUBLE DOOR INSTALLATION

PART CODE	QTY	DESCRIPTION
CD	2	Doors
HS	12	Hinge screw

5.5 - ASSEMBLY – DOUBLE DOOR INSTALLATION

Hold door in position, 3mm down from top. Front of the door when closed will be flush with front of VJ cladding.

Screw through hinge into front wall (as pictured).

Repeat steps with other door.

Note: door centre gaps can be adjusted by unscrewing wall to floor fixing and moving in and out.



STEP 5.6

PAD BOLT INSALLATION

5.6 - ASSEMBLY PARTS – PAD BOLT INSTALLATION

PART CODE	QTY	DESCRIPTION
PB	2	Pad bolt
HS	8	Hinge Screw

5.6 - ASSEMBLY – PAD BOLT INSTALLATION

Hold PB in position and fasten to door. Mark centre of bolt and drill 12mm hole in marked closed position. Repeat for bottom pad bolt.



- The T handle must be installed on the opposite door to the pad bolted door (fixed door)

STEP 5.7

DOOR HANDLE ASSEMBLY

5.7 - ASSEMBLY PARTS – DOOR HANDLE ASSEMBLY

PART CODE	QTY	DESCRIPTION
TH	1	T Handle

5.7 - ASSEMBLY – DOOR HANDLE ASSEMBLY

Mark and drill 12mm centre hole in position shown, 50mm in from door edge. T Handle must be installed centre of the centre door brace (on the back)
Insert T handle in position and mark two outside holes. Remove T handle and drill 2 x 6mm holes.

Insert T handle back in with bolts, and fasten nuts on back of door.



STEP 5.8

DOOR HANDLE ASSEMBLY

5.8 - ASSEMBLY PARTS – DOOR HANDLE ASSEMBLY

PART CODE	QTY	DESCRIPTION
	1	T Handle Lever
DP	1	Packer
HS	2	Hinge screw

5.8 - ASSEMBLY – DOOR HANDLE ASSEMBLY

Holding DP in position, fasten to door (door with pad bolts)

Holding door in closed position, flush with other door - slide lever onto T Handle and tighten once hitting packer on fixed door.



Leaver

DP



STEP 6.0

CORNER POST ASSEMBLY

6.0 - ASSEMBLY PARTS – CORNER POST ASSEMBLY		
PART CODE	QTY	DESCRIPTION
CP	4	1890mm Corner Post
40N	24	40mm Nail
6.0 - ASSEMBLY – CORNER POST ASSEMBLY		
Hold corner post (CP) in position, nail through CP into wall stud using 6x 40N evenly spaced along CP. Repeat for all four corners.		
Note: Before nailing CPs, we recommend running a bead of silicone down the lines seen below.		

Recommended: Run a bead of silicone down these two lines before nailing CPs

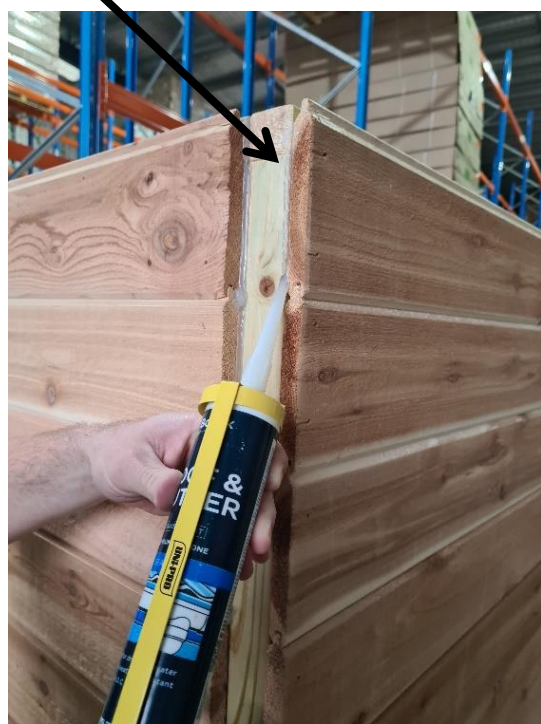

Nail 6x 40N evenly spaced along CP



STEP 6.1

COVER STRIP ASSEMBLY

6.1 - ASSEMBLY PARTS – COVER STRIP ASSEMBLY

PART CODE	QTY	DESCRIPTION
CP	3	1890mm Cover Strip
40N	18	40mm Nail

6.1 - ASSEMBLY – COVER STRIP ASSEMBLY

Hold cover strips (CS) over joins in walls, nail through CS into wall panel using 6x 40N evenly spaced per CS.

Note: Before nailing CS, we recommend running a bead of silicone down the joins in the wall, as seen below.



STEP 6.2

FASCIA ASSEMBLY

6.2 - ASSEMBLY PARTS – FASCIA ASSEMBLY

PART CODE	QTY	DESCRIPTION
F	4	Fascia
40N	12	40mm Nail

6.2 - ASSEMBLY – FASCIA ASSEMBLY

Hold fascia's in position. Flush with bottom of battens and meeting evenly at the top. Nail into end of Battens.



STEP 6.3

RIDGE CAP INSTALLATION

6.3 - ASSEMBLY PARTS – RIDGE CAP INSTALLATION

PART CODE	QTY	DESCRIPTION
RC	2	1200mm Ridge Cap
40RS	6	40mm Roof screw

6.3 - ASSEMBLY – RIDGE CAP INSTALLATION

Slide 2 ridge caps into position. Make sure peak of ridge cap is in line with peak of fascia's. Screw through ridge cap into 2nd rib in from end and through into batten.

Repeat this on both ends.

Screw through overlap in center on both sides.



STEP 6.4

FIXING TO BASE

6.4 - FIXING TO BASE

PART CODE	QTY	DESCRIPTION
65HHS	9	65mm Hex head screw

6.4 - FIXING TO BASE

Screw through base plates on wall frames in positions shown below using 65HHS screws. If floor not purchased fixings are not provided

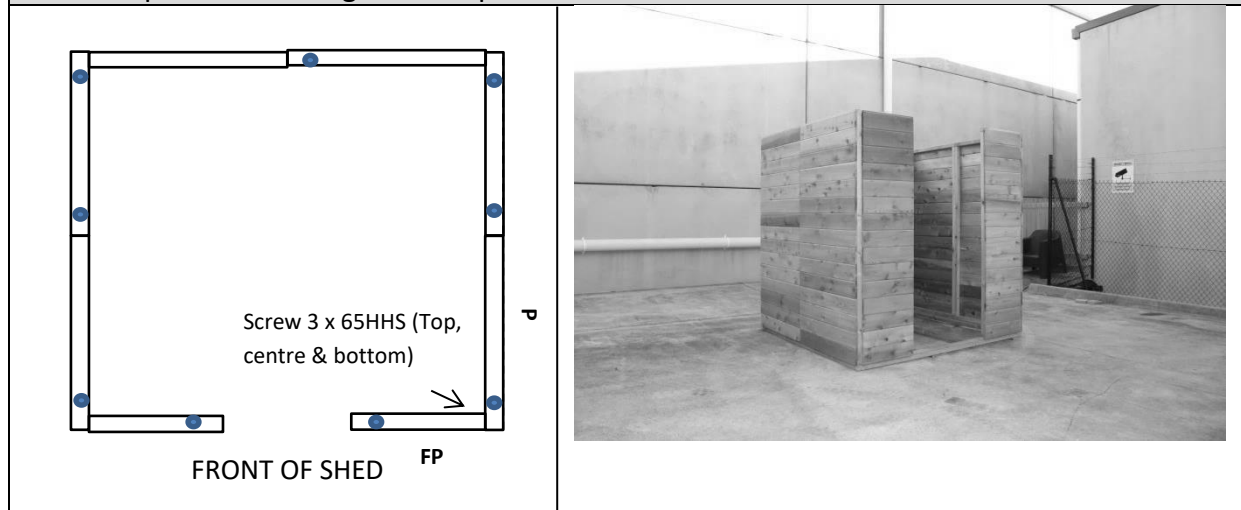

If installing on a concrete slab – use 100mm long 10mm round dyna bolts through frame in the same positions.



IMAGES TO HELP WITH INSTALLATION

FLOOR













TO REGISTER YOUR WARRANTY

Thank-you for purchasing a STILLA product. To register your 10 year product warranty, please go to www.stilla.com.au/warranty and complete the online form. We recommend that you complete this step once you have finished installing your product.

PLEASE NOTE THAT IF YOU DO NOT COMPLETE THIS WARRANTY REGISTRATION FORM – YOUR PRODUCT IS NOT COVERED BY WARRANTY.

PRODUCT MAINTENANCE

We highly recommend you coat the external of your product with Intergrain UltraDeck Timber Stain – in the Colour Light Oak. This product is available from Dulux paint stores or Bunnings stores that have a paint section. The product is re tinted from a Cedar Cypress base to achieve the light oak colour – Intergrain is a Cabot's product (Having issues – Bring up Cabot's page on the paint desk computer and type Light Oak – this should bring up the formula)







SHOW US YOUR SHED

We would love to see a photo of your STILLA product installed in your backyard. Please upload this image when completing the warranty registration. Alternatively, you can send the photos by email to sales@stilla.com.au.

If you require any assistance, please feel free to call or email.

Kind regards,

STILLA Customer Support

1800 784 552 | sales@stilla.com.au

